

### Maxillary tubes



Angulation	Torque	Distal Offset	Width	Headgear	Right/Left	.018 Arch Slot		.022 Arch Slot	
						On Bases	Tube Only/ On Bands	On Bases	Tube Only/ On Bands

#### First Molar

Double with Hook

0°	-14°	14°	4.6mm		R	A08216	A05616	A08218	A05618
					L	A08217	A05617	A08219	A05619

Single with Hook

0°	-10°	0°	4.6mm		R	A08730	A06730	A08734	A06734
					L	A08731	A06731	A08735	A06735

0°	-10°	10°	4.6mm		R	A18750		A18754	
					L	A18751		A18755	

0°	-14°	10°	4.6mm		R	A08562	A05422	A08566	A05522
					L	A08563	A05423	A08567	A05523

0°	-14°	14°	4.6mm		R	A08200	A05600	A08202	A05602
					L	A08201	A05601	A08203	A05603

#### Second Molar

Single with Hook

0°	-10°	0°	3.6mm		R	A08732	A06732	A08736	A06736
					L	A08733	A06733	A08737	A06737

0°	-10°	10°	3.6mm		R	A18752		A18756	
					L	A18753		A18757	

0°	-14°	10°	3.6mm		R	A08564	A05424	A08568	A05524
					L	A08565	A05425	A08569	A05525

0°	-14°	14°	3.6mm		R	A08204	A05604	A08206	A05606
					L	A08205	A05605	A08207	A05607



Markings  
Right: Black  
Left: Green

# bracket & tube systems

FLI® BUCCAL TUBES

## Mandibular tubes

Angulation	Torque	Distal Offset	Width	Headgear	Right/Left	.018 Arch Slot		.022 Arch Slot	
						On Bases	Tube Only/ On Bands	On Bases	Tube Only/ On Bands
<b>First Molar</b>									
Double with Hook									
-1°	-30°	4°	4.6mm		R	A08220	A05620	A08222	A05622
Not preangulated					L	A08221	A05621	A08223	A05623
Single with Hook									
0°	-10°	0°	4.6mm		R	A08766	A06766	A08768	A06768
					L	A08767	A06767	A08769	A06769
0°	-20°	0°	4.6mm		R	A08572	A05426	A08576	A05526
					L	A08573	A05427	A08577	A05527
0°	-25°	0°	4.6mm		R	A08740	A06740	A08744	A06744
					L	A08741	A06741	A08745	A06745
0°	-25°	5°	4.6mm		R	A18758		A18762	
					L	A18759		A18763	
-1°	-30°	4°	4.6mm		R	A08208	A05608	A08210	A05610
Not preangulated					L	A08209	A05609	A08211	A05611
<b>Second Molar</b>									
Single with Hook									
0°	-10°	0°	3.6mm		R	A08574	A05428	A08578	A05528
					L	A08575	A05429	A08579	A05529
0°	-25°	0°	3.6mm		R	A08742	A06742	A08746	A06746
					L	A08743	A06743	A08747	A06747
0°	-25°	5°	3.6mm		R	A18760		A18764	
					L	A18761		A18765	
-1°	-30°	4°	3.6mm		R	A08212	A05612	A08214	A05614
Not preangulated					L	A08213	A05613	A08215	A05615

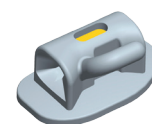

Markings  
Right: Red  
Left: Yellow

## Mini tubes

Angulation	Torque	Distal Offset	Width	Right/Left	.018 Arch Slot		.022 Arch Slot		
					ID	ID			
<b>Second Molar</b>									
0°	0°	0°	2.5mm	UR/LL	A18770	A18780	◆		
				UL/LR	A18771	A18781	◆		
0°	-10°	0°	2.5mm	UR	A18772	A18782	●		
				UL	A18773	A18783	●		
0°	-14°	0°	2.5mm	UR/LL	A18774	A18784	●		
				UL/LR	A18775	A18785	●		
0°	-25°	0°	2.5mm	LR	A18776	A18786	■		
				LL	A18777	A18787	■		